



FI15 SERIES

ND15 FILTER

Filters



[PDF FILE](#)

Description

- Very easy change of the Monel filter cartridge (no need to dismount the filter from the line).
- Flow characteristics optimized.
- Oxygen adiabatic compression tests performed by CTE at 360 bar.

Working Conditions

- Industrial gases : Oxygen, Hydrogen, Neutral and Rare gases, others on request.
- Medical gases : Oxygen, N2O, Medical air...
- Working pressure : from vacuum up to 360 bar.
- Working temperature : -40°C up to +80°C.

Connections

- Stainless steel welded connectors 1/2" Sch 80, 3/4" Sch 160, others on request.
- Monel welded connectors as an option.
- Other connectors on request.

Technical Data

- Nominal diameter : 15 mm.
- Material : brass.
- 20 or 60 micron filtration.
- O-Ring according to customer needs.

Options

- Brass connectors, screwed connectors.
- Specific connectors for SisNovam valves.
- ATEX version.

Overall Dimensions (mm)

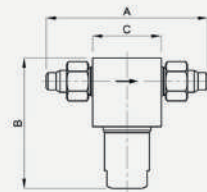

Filter mounted on valves series:
DN15 / 20. Inlet and outlet
connector to weld for pipe 1/2"
BW.
A = 200
B = 162
C = 95